



Elsan Elektrik San. ve Tic. A.Ş  
 Etiler Mah. 1458 Cad. No:40  
 06790 Etimesgut / Ankara / TÜRKİYE  
 Tlf: +90 312 244 09 94 F: +90 312 243 14 38  
 Mail: info@emtas.com.tr / Web Sayfası: www.emtas.com.tr



## TECHNICAL SPECIFICATION SHEET

### THREE PHASES SQUIRREL CAGE ASYNCHRONOUS MOTOR

Type	NMST 200L 4	
Protection Class	IP55	
Duty Type / Service Factor	S2 240 dak	1.0
Insulation Class	F	
Construction Type /Frame	V5-V6-B6-B7-B8	V1-V3
Altitude / Ambient temperature	V1-V3	40 °C

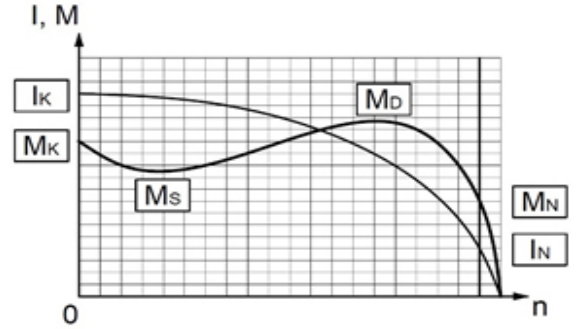

## PERFORMANCE DATA ( FULL LOAD )

Output Rated (kW)	Speed (1/min)	Voltage (V)	Frequency (Hz)	Current (A)	Efficiency (%)	Power Factor (CosØ)	Rated Torque MN (Nm)	Starting Current IK/IN	Starting Torque MK/MN	Breakdown Torque MD/MN	Moment of Inertia Jmot kgm2
30	1470	400	50	54.3	90.7	0.88	194.9	6.5	2.5	2.8	0.2069

## CHARACTERISTIC DATA

Frame	Pik Cast. (GG20)	BEARINGS	Drive End Bearing		Non Drive End Bearing		
Front-Back Cover	Pik Cast. (GG20)		Standart	6313 ZZ		6313 ZZ	
Foot	Sfero Casting		Heavy Duty	NU 313		6313 ZZ	
Fan	Plastik	Special Equipment	Brake	Forced ventilation	Heater	Encoder	Heat Sensor
Terminal Box	Casting		---	---	---	---	---
Cable Gland	Casting	Colour	RAL 6028-Yesil		Weight (kg)	228	

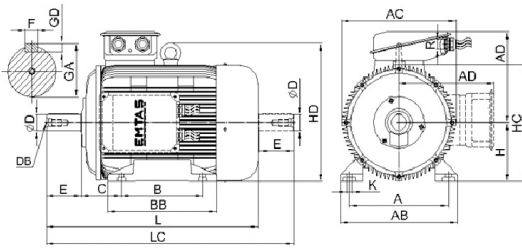

## DIMENSIONS (B3-B5-V5-V6-B6-B7-B8)

B3										B5							Common Dimensions										
H	A	B	C	AB	AC	AD	BB	HC	HD	K	P	N	M	S	D.S	T.	LA	LB	LC	L	ØD	E	F	GA	GD	DB	R
200L	318	305	133	400	385	319	365	394	460	19	400	300	350	19	4		18		876	759	55	110	16	59	10	*	2 x Pg21