



Elsan Elektrik San. ve Tic. A.Ş
 Etiler Mah. 1458 Cad. No:40
 06790 Etimesgut / Ankara / TÜRKİYE
 Tlf: +90 312 244 09 94 F: +90 312 243 14 38
 Mail: info@emtas.com.tr / Web Sayfası: www.emtas.com.tr



TECHNICAL SPECIFICATION SHEET

THREE PHASES SQUIREL CAGE ASYNCHRONOUS MOTOR		
Type	NMST 132M 8	
Protection Class	IP55	
Duty Type / Service Factor	S2 240 dak	1.0
Insulation Class	F	
Construction Type /Frame	V5-V6-B6-B7-B8	V1-V3
Altitude / Ambient temperature	V1-V3	40 °C



PERFORMANCE DATA (FULL LOAD)

Output Rated (kW)	Speed (1/min)	Voltage (V)	Frequency (Hz)	Current (A)	Efficiency (%)	Power Factor (CosØ)	Rated Torque MN (Nm)	Starting Current IK/IN	Starting Torque MK/MN	Breakdown Torque MD/MN	Moment of Inertia Jmot kgm2
3	707	400	50	7.6	77.0	0.74	40.5	4.4	2.1	2.3	0.0419

CHARACTERISTIC DATA

Frame	Pik Cast. (GG20)	BEARINGS	Drive End Bearing		Non Drive End Bearing		
Front-Back Cover	Pik Cast. (GG20)		Standart	6308 ZZ		6308 ZZ	
Foot	Sfero Casting		Heavy Duty	NU 308		6308 ZZ	
Fan	Plastik	Special Equipment	Brake	Forced ventilation	Heater	Encoder	Heat Sensor
Terminal Box	Casting		---	---	---	---	---
Cable Gland	Casting	Colour	RAL 6028-Yesil		Weight (kg)		73

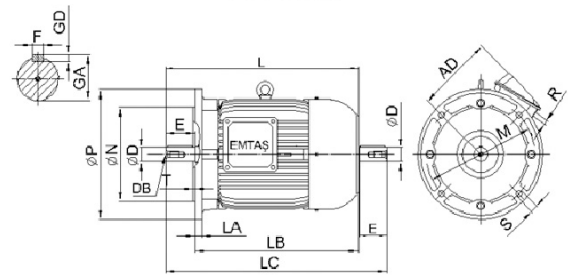
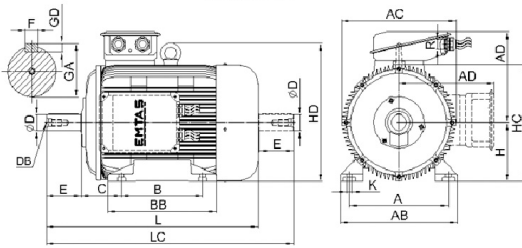

DIMENSIONS (B3-B5-V5-V6-B6-B7-B8)

B3										B5						Common Dimensions											
H	A	B	C	AB	AC	AD	BB	HC	HD	K	P	N	M	S	D.S	T.	LA	LB	LC	L	ØD	E	F	GA	GD	DB	R
132M	216	178	89	270	258	207	218	261	309	12	300	230	265	15	4		18		578	492	38	80	10	41	8	*	2 x Pg21