



Elsan Elektrik San. ve Tic. A.Ş  
 Etiler Mah. 1458 Cad. No:40  
 06790 Etimesgut / Ankara / TÜRKİYE  
 Tlf: +90 312 244 09 94 F: +90 312 243 14 38  
 Mail: info@emtas.com.tr / Web Sayfası: www.emtas.com.tr



## TECHNICAL SPECIFICATION SHEET

### THREE PHASES SQUIREL CAGE ASYNCHRONOUS MOTOR

Type	NMST 225S 8	
Protection Class	IP55	
Duty Type / Service Factor	S1	1.0
Insulation Class	F	
Construction Type /Frame	V5-V6-B6-B7-B8	V1-V3
Altitude / Ambient temperature	V1-V3	40 °C

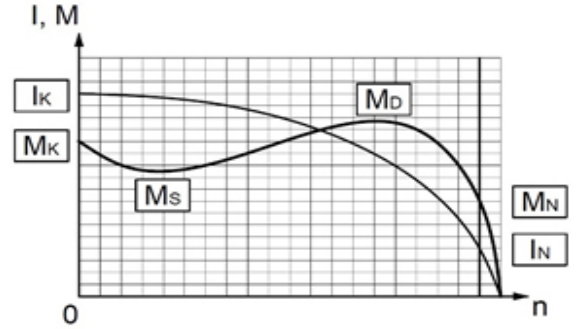

## PERFORMANCE DATA ( FULL LOAD )

Output Rated (kW)	Speed (1/min)	Voltage (V)	Frequency (Hz)	Current (A)	Efficiency (%)	Power Factor (CosØ)	Rated Torque MN (Nm)	Starting Current IK/IN	Starting Torque MK/MN	Breakdown Torque MD/MN	Moment of Inertia Jmot kgm2
18.5	728	400	50	38.0	89.0	0.79	242.7	6.0	1.9	2.7	0.5964

## CHARACTERISTIC DATA

Frame	Pik Cast. (GG20)	BEARINGS	Drive End Bearing		Non Drive End Bearing		
Front-Back Cover	Pik Cast. (GG20)		Standart	6314		6314	
Foot	Sfero Casting		Heavy Duty	NU 314		6314	
Fan	Plastik	Special Equipment	Brake	Forced ventilation	Heater	Encoder	Heat Sensor
Terminal Box	Casting		---	---	---	---	---
Cable Gland	Casting	Colour	RAL 6028-Yesil		Weight (kg)		260

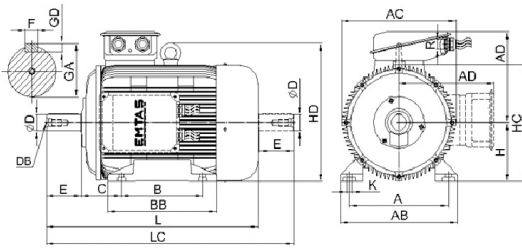

## DIMENSIONS (B3-B5-V5-V6-B6-B7-B8)

B3										B5							Common Dimensions										
H	A	B	C	AB	AC	AD	BB	HC	HD	K	P	N	M	S	D.S	T.	LA	LB	LC	L	ØD	E	F	GA	GD	DB	R
225S	356	286	149	436	434	300	346	442	504	19	450	350	400	19	8		18		940	793	60	140	18	64	11	M20	2 x Pg36