



Elsan Elektrik San. ve Tic. A.Ş
 Etiler Mah. 1458 Cad. No:40
 06790 Etimesgut / Ankara / TÜRKİYE
 Tlf: +90 312 244 09 94 F: +90 312 243 14 38
 Mail: info@emtas.com.tr / Web Sayfası: www.emtas.com.tr



TECHNICAL SPECIFICATION SHEET

THREE PHASES SQUIREL CAGE ASYNCHRONOUS MOTOR		
Type	NMST 225M 8	
Protection Class	IP55	
Duty Type / Service Factor	S1	1.0
Insulation Class	F	
Construction Type /Frame	V5-V6-B6-B7-B8	V1-V3
Altitude / Ambient temperature	V1-V3	40 °C



PERFORMANCE DATA (FULL LOAD)

Output Rated (kW)	Speed (1/min)	Voltage (V)	Frequency (Hz)	Current (A)	Efficiency (%)	Power Factor (CosØ)	Rated Torque MN (Nm)	Starting Current IK/IN	Starting Torque MK/MN	Breakdown Torque MD/MN	Moment of Inertia Jmot kgm2
22	730	400	50	41.9	93.6	0.81	287.8	6.0	1.9	2.7	0.7147

CHARACTERISTIC DATA

Frame	Pik Cast. (GG20)	BEARINGS	Drive End Bearing		Non Drive End Bearing		
Front-Back Cover	Pik Cast. (GG20)		Standart	6314		6314	
Foot	Sfero Casting		Heavy Duty	NU 314		6314	
Fan	Plastik	Special Equipment	Brake	Forced ventilation	Heater	Encoder	Heat Sensor
Terminal Box	Casting		---	---	---	---	---
Cable Gland	Casting	Colour	RAL 6028-Yesil		Weight (kg)		354

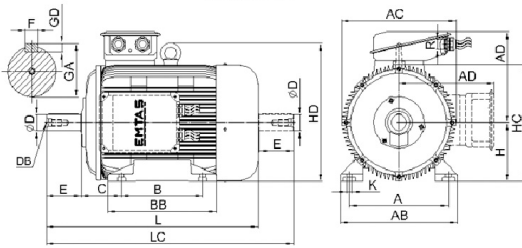

DIMENSIONS (B3-B5-V5-V6-B6-B7-B8)

B3										B5							Common Dimensions										
H	A	B	C	AB	AC	AD	BB	HC	HD	K	P	N	M	S	D.S	T.	LA	LB	LC	L	ØD	E	F	GA	GD	DB	R
225M	356	311	149	436	434	300	371	442	504	19	450	350	400	19	8		18		965	818	60	140	18	64	11	M20	2 x Pg36